

Compressor to Condenser Discharge Line

Material

Item	Specification
Motorcraft® PAG Refrigerant Compressor Oil YN-12-D	WSH-M1C231-B

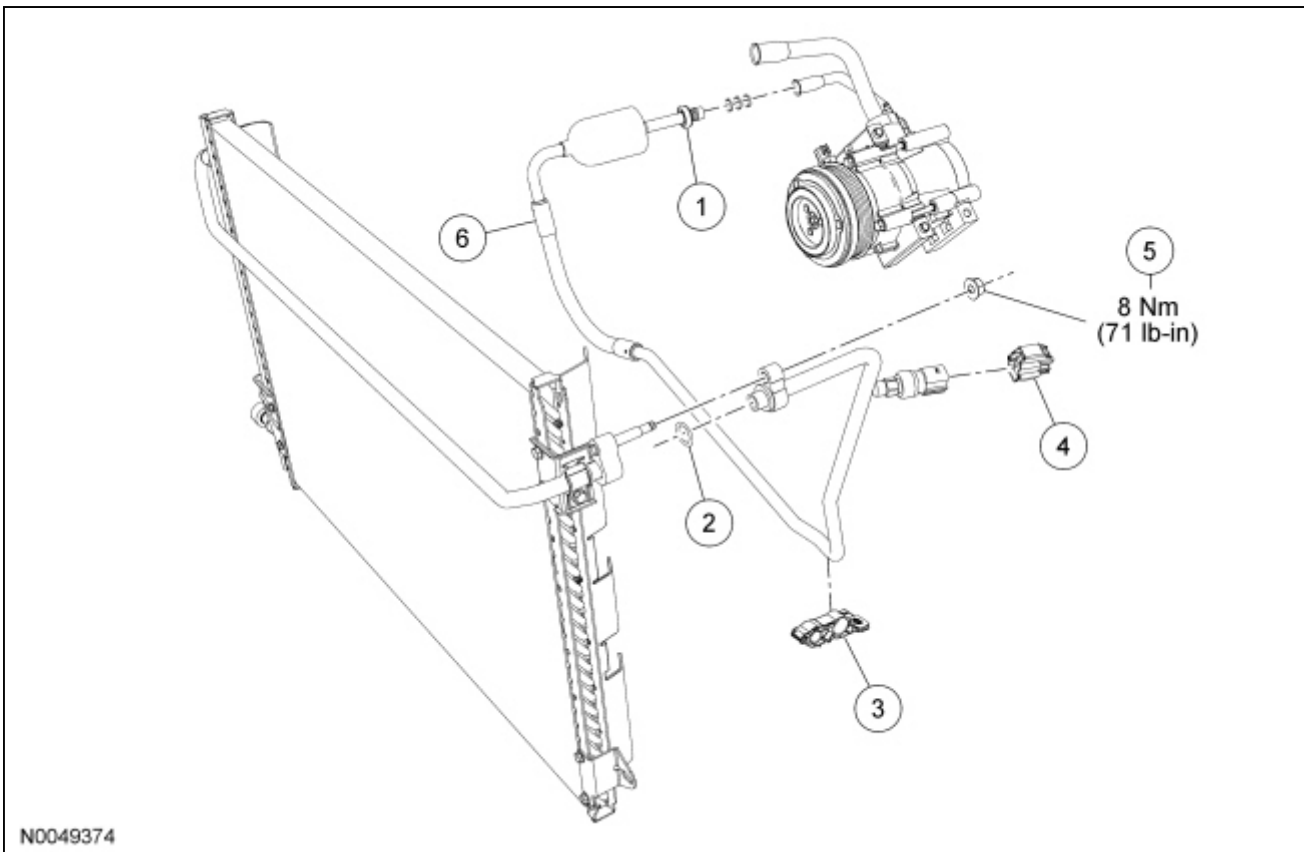

Item	Part Number	Description
1	—	Compressor discharge fitting (part of 19972)
2	19E889	O-ring (4 required)
3	19B632	A/C line bracket
4	—	Dual-function pressure switch electrical connector (part of 12B637)
5	W520413	Condenser inlet fitting nut
6	19972	Compressor-to-condenser discharge line

Removal and Installation

5.4L (4V) vehicles

1. With the vehicle in NEUTRAL, position it on a hoist. For additional information, refer to [Section 100-02](#).

4.6L vehicles

2. Remove the Air Cleaner (ACL) outlet tube. For additional information, refer to [Section 303-12](#).

All vehicles

3. Recover the refrigerant. For additional information, refer to [Section 412-00](#).
 4. Disconnect the compressor discharge fitting.
 - Discard the O-ring seals.
 5. Disconnect the dual-function pressure switch electrical connector and remove the dual-function pressure switch.
 6. Remove the condenser inlet fitting nut and disconnect the fitting.
 - Discard the O-ring seal.
 - To install, tighten to 8 Nm (71 lb-in).
 7. Detach the compressor-to-condenser discharge line from the A/C line bracket.
 8. Remove the compressor-to-condenser discharge line.
 9. To install, reverse the removal procedure.
 - Install new O-ring seals.
 - Lubricate the refrigerant system with the correct amount of clean PAG oil. For additional information, refer to [Section 412-00](#).
 10. Evacuate, leak test and charge the refrigerant system. For additional information, refer to [Section 412-00](#).
-